

# YASKAWA

# MOTOMAN MPX3500

## Painting with the MPX3500



The fast and flexible MOTOMAN MPX3500 offers high performance in painting automobile bodies, bumpers, construction equipment and further more.

A high-density layout saves space by reducing the size of the painting booth. The L axis is designed with no offset to enable installation of the manipulator closer to a work piece, which saves space.

The time required for teaching large cells can be shortened by converting the data created for the robot on one side for the robot on the opposite side.

The hoses and tubes of the MOTOMAN MPX3500 can be routed inside the wrist section to prevent interferences. The process arm and high payload of this robot allows the mounting of large bell applicators, which enable multi-color painting.

The MOTOMAN MPX3500 is controlled by the high-performance MOTOMAN DX200 controller, which is available with the optional Functional Safety Unit (FSU) that offers a wide range of new safety functions.

### KEY BENEFITS

- Flexible, fast and versatile
- Compact design
- Large motion range: Front area 2700 mm; wall mounted 3500 mm
- High Payload of wrist: 15 kg
- Process arm with enough space for potential separator and process technology
- Easy programming and installation
- Great availability

Controlled by  
**DX200**



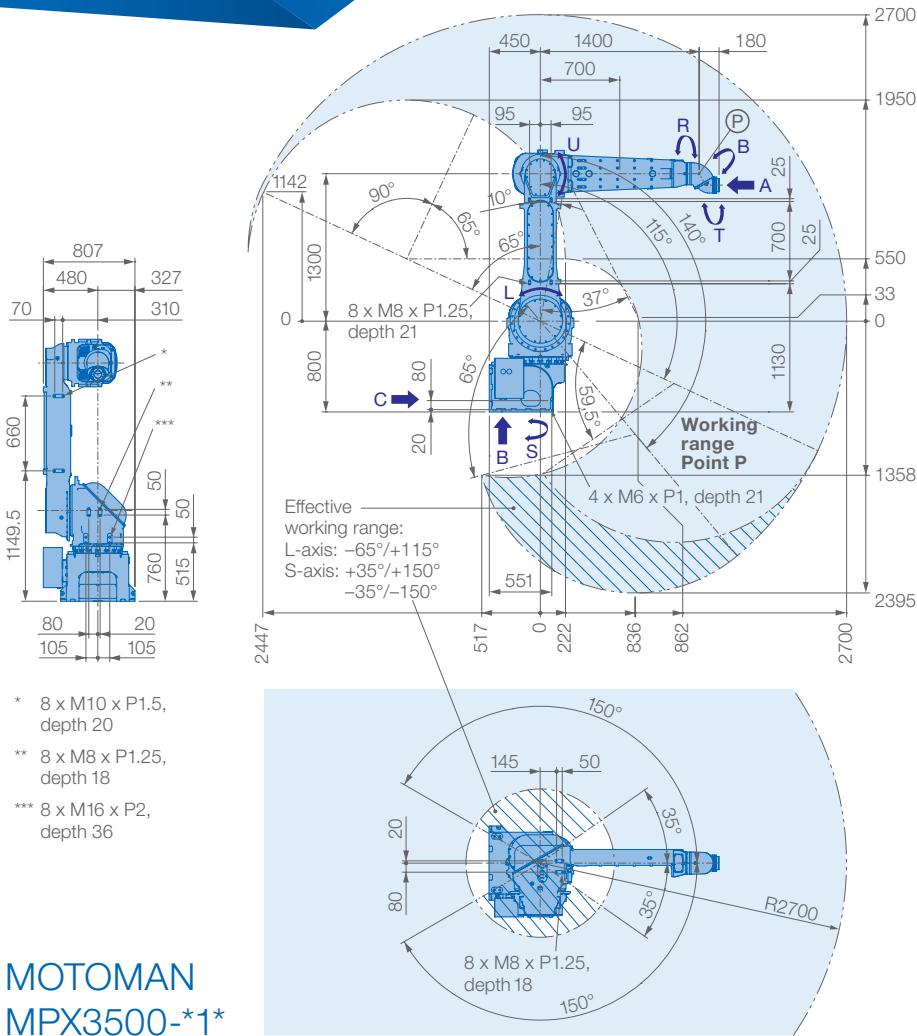

View A

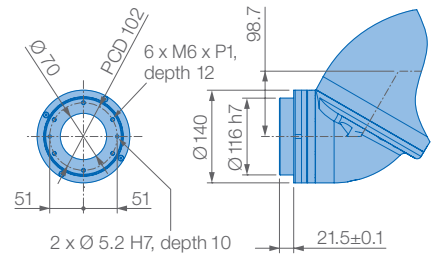

View B

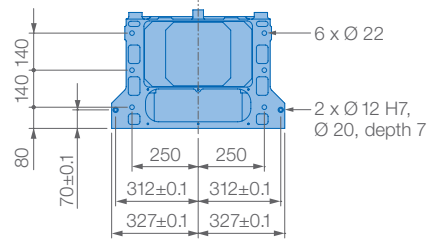

View C

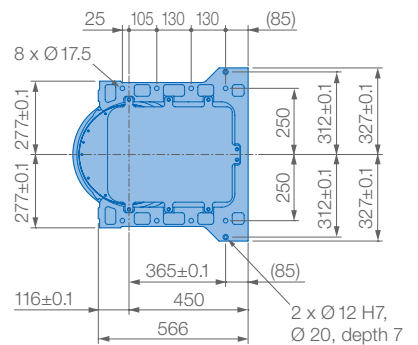

Mounting options: Floor, ceiling, wall

Protection class: IP4X/67

MOTOMAN  
MPX3500-\*1\*

**ATEX Category 2: MPX3500-Cxx[x]**

**Ex** II 2 G Ex ib pxb IIB T4 Gb  
Ta = 0°C to 40°C



**ATEX Category 3: MPX3500-Fxx[x]**

**Ex** II 3 G D Ex nA h IIC T4 Gc  
Ex tc h IIC T135°C Dc  
Ta = 0°C to 40°C



**Allowable wrist load**

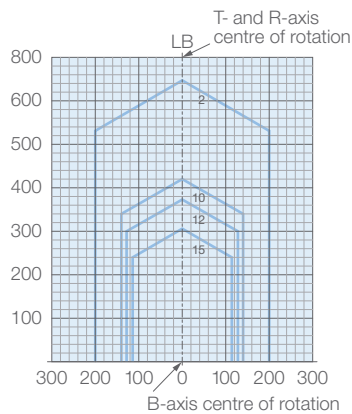

**Specifications MPX3500-\*0\* / MPX3500-\*1\***

Axes	Maximum motion range [°]	Maximum speed [°/s]	Allowable moment [Nm]	Allowable moment of inertia [kg · m <sup>2</sup> ]	Controlled axes	6
S	±150	100	-	-	Max. payload [kg]	15
L	+140/-65	100	-	-	Repeatability [mm]	±0.15
U	+90/-65	110	-	-	Max. working range R [mm]	2700
R	±720	300	93.2	3.75	Temperature [°C]	0 to +40
B	±720	360	58.8	2.23	Humidity [%]	20 - 80
T	±720	360	19.6	0.20	Weight [kg]	560
					Power supply, average [kVA]	3

## YASKAWA GROUP

AT Yaskawa Austria  
Schwechat/Wien  
+43(0)1-707-9324-15

CZ Yaskawa Czech s.r.o.  
Rudná u Prahy +420-257-941-718

ES Yaskawa Ibérica, S.L.  
Gavà/Barcelona +34-93-6303478

FR Yaskawa France SARL  
Le Bignon +33-2-40131919

FI Yaskawa Finland Oy  
Turku +358-(0)-403000600

GB Yaskawa UK Ltd.  
Banbury +44-1295-272755

IT Yaskawa Italia s.r.l.  
Torino +39-011-9005833

IL Yaskawa Europe Technology Ltd.  
Rosh Ha'ayin +972-3-9004114

NL Yaskawa Benelux B.V.  
Eindhoven +31-40-2895500

PL Yaskawa Polska Sp. z o.o.  
Wrocław +48-71-7928670

RU Yaskawa Europe Holding AB  
Moskva +46-480-417-800

SE Yaskawa Nordic AB  
Torsås +46-480-417-800

SI Yaskawa Slovenia  
Ribnica +386-1-8372-410

TR Yaskawa Turkey Elektrik  
Ticaret Ltd. Sti.  
İstanbul +90-216-5273450

ZA Yaskawa Southern Africa (PTY) Ltd  
Johannesburg +27-11-6083182

## DISTRIBUTORS

BG ARAMET ROBOTICS Ltd.  
Yambol +359-885 317 294  
Kammarton Bulgaria Ltd.  
Sofia +359-02-926-6060

DK Robotcenter Danmark  
Løsning +45 7022 2477

EE RKR Seadmed OÜ  
Tallinn/Estonia +372-68-35-235

GR Gizelis Robotics  
Schimatari Viotias +30-2262057199

HU Flexman Robotics Kft  
Budapest +36 1 259 0981

LT Profibus UAB  
Panevezys +370-45-518575

NO Skala Robotech AS  
Lierstranda +47-32240600

PT ROBOPLAN Lda  
Aveiro +351-234 943 900

RO Sam Robotics srl  
Timisoara +40 720 279 866  
MPL Automation S.R.L.  
Satu Mare +40 261 750 741  
NORMANDIA S.R.L.  
Braşov +40 268 549 236



All drawing dimensions in mm.  
Technical data may be subject to change without previous notice.  
Please request detailed drawings at [robotics@yaskawa.eu.com](mailto:robotics@yaskawa.eu.com).

YR-MPX3500-10\*, YR-MPX3500-11\*  
D-03-2019, A-No. 176061

# YASKAWA